

RADIAL - INCH

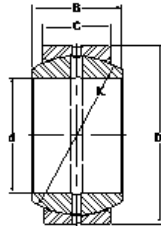

Part Number	d Inside Diameter Nom.	D Outside Diameter	B Inner Ring Width	C Outer Ring Width	K Spherical Diameter (REF)	Recommended Load Limits		
						Static Radial (lbf)	Static Thrust (lbf)	Dynamic Radial (lbf)
B12-L	0.75	1.25	0.656	0.562	1.08	21200	3900	5300
B14-L	0.875	1.4375	0.765	0.656	1.258	28800	5400	7200
B16-L	1	1.625	0.875	0.75	1.437	37700	7300	9400
B20-L	1.25	2	1.093	0.937	1.795	58800	11900	14700
B22-L	1.375	2.1875	1.187	1.031	1.937	69800	13500	17400
B24-L	1.5	2.4375	1.312	1.125	2.155	84800	16600	21200
B28-L	1.75	2.8125	1.531	1.312	2.515	115400	23600	28800
B32-L	2	3.1875	1.75	1.5	2.875	150900	31900	37700
B36-L	2.25	3.5625	1.969	1.687	3.235	191000	42000	47700
B40-L	2.5	3.9375	2.187	1.875	3.59	235500	52900	58800
B44-L	2.75	4.375	2.406	2.062	3.95	285000	62600	71200
B48-L	3	4.75	2.625	2.25	4.312	339500	76300	84800
B52-L	3.25	5.125	2.844	2.437	4.675	398700	91500	99600
B56-L	3.5	5.5	3.062	2.625	5.04	463000	109200	115700
B60-L	3.75	5.875	3.281	2.812	5.39	530400	126100	132600
B64-L	4	6.25	3.5	3	5.75	603700	144500	150900
B72-9L	4.5	7	3.937	3.375	6.475	764800	290400	191200
B80-9L	5	7.75	4.375	3.75	7.19	943600	360900	235900
B96-9L	6	8.75	4.75	4.125	8.156	1177000	387600	294200
B104-9L	6.5	9.75	4.875	4.062	8.775	1247000	299700	311700
B112-9L	7	10.5	5.25	4.375	9.45	1447000	431100	361700
B120-9L	7.5	11.25	5.625	4.687	10.125	1660000	506500	415000
B128-9L	8	12	6	5	10.8	1890000	582400	472500

RADIAL - METRIC

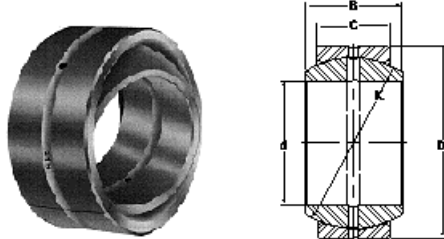

Part Number	d Inside Diameter Nom.	D Outside Diameter	B Inner Ring Width	C Outer Ring Width	K Spherical Diameter (REF)	Recommended Load Limits		
						Static Radial (kN)	Static Thrust (kN)	Dynamic Radial (kN)
MB12	12	22	10	7	19	57	8.3	11.4
MB15	15	26	12	9	22	85	13.7	17
MB17	17	30	14	10	25	107	16.9	21.5
MB20	20	35	16	12	30	155	24.3	31
MB25	25	42	20	16	36	248	43.2	49.5
MB30	30	47	22	18	41	317	54.7	63.5
MB35	35	55	25	20	48	413	67.5	82.6
MB40	40	62	28	22	55	520	81.7	104
MB45	45	68	32	25	60	645	106	129
MB50	50	75	35	28	67	807	132	161
MB60	60	90	44	36	81	1250	216	250
MB70	70	105	49	35	94	1620	270	325
MB80	80	120	55	40	107	2070	342	410
MB90	90	130	60	45	117	2520	422	500
MB100	100	150	70	50	134	3200	510	640
MB110	110	160	70	55	143	3400	510	680
MB120	120	180	85	70	160	4800	830	960
MB140	140	210	90	70	187	5600	830	1120
MB160-9L	160	230	105	80	206	7100	1100	1420
MB180-9L	180	260	105	80	234	8000	1100	1600
MB200-9L	200	290	130	100	265	11400	1700	2300
MB220-9L	220	320	135	100	286	12300	1700	2500



寧波安牧國際貿易有限公司

NINGBO AMOL INTL. TRADE CO.,LTD.

Spherical Plain Bearing/Rod Ends

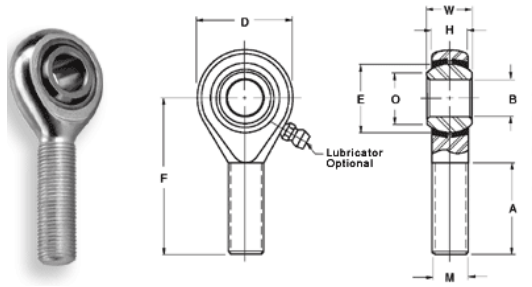

Part Number	Bore	Ball Width	Housing Width	Head Diameter	Length to Center of Ball	Thread Length	Thread Size	Ball Diameter	Ball Flat Diameter	Max Static Radial Load	Approx Weight
Dimensions in Inches										lbf	lb
	B	W	H	D	F	A	M	E	O		
	+0.015 -0.005	+0.000 -0.005	+0.005 -0.005	+0.010 -0.010	+0.010 -0.010	+0.062 -0.031	UNF-3A	REF	REF		
HM3	0.1900	0.3120	0.2500	0.6250	1.2500	0.7500	.1900-32	0.4370	0.3060	900	0.03
HM4	0.2500	0.3750	0.2810	0.7500	1.5620	1.0000	.2500-28	0.5150	0.3530	1,700	0.05
HM5	0.3125	0.4370	0.3440	0.8750	1.8750	1.2500	.3125-24	0.6250	0.4470	2,500	0.08
HM6	0.3750	0.5000	0.4060	1.0000	1.9380	1.2500	.3750-24	0.7180	0.5160	4,000	0.12
HM7	0.4375	0.5620	0.4370	1.1250	2.1250	1.3750	.4375-20	0.8120	0.5860	5,000	0.17
HM8	0.5000	0.6250	0.5000	1.3120	2.4380	1.5000	.5000-20	0.9370	0.6980	7,000	0.26
HM10	0.6250	0.7500	0.5620	1.5000	2.6250	1.6250	.6250-18	1.1250	0.8390	8,050	0.41
HM12	0.7500	0.8750	0.6870	1.7500	2.8750	1.7500	.7500-16	1.3120	0.9780	11,300	0.64
HM16	1.0000	1.3750	1.0000 [4]	2.7500 [4]	4.1250	2.1250	1.2500-12	1.8750	1.2750	28,400	2.25



寧波安牧國際貿易有限公司

NINGBO AMOL INTL. TRADE CO.,LTD.

Spherical Plain Bearing/Rod Ends

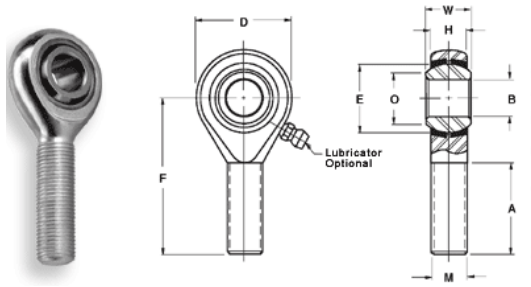

Part Number	Bore	Ball Width	Housing Width	Head Diameter	Length to Center of Ball	Thread Length	Thread Size	Ball Diam.	Ball Flat Diam.	Max Static Radial Load		Approx Weight
										lbf	lbf	
Dimensions in Inches										with lubricator	without lubricator	lb
	B	W	H	D	F	A	M	E	O			
	+0.015 -.0005	+0.000 -.005	+0.005 -.005	+0.010 -.010	+0.010 -.010	+0.062 -.031	UNF-3A	REF	REF			
HMX4G	.2500	.2500	.2810	0.7500	1.5620	1.0000	.3125-24	0.5150	.3530	3,260	6,680	0.06
HMX5G	.3125	.3125	.3440	0.8750	1.8750	1.2500	.3750-24	0.6250	.4470	4,920	8,410	0.09
HMX6G	.3750	.3750	.4060	1.0000	1.9380	1.2500	.4375-20	0.7180	.5160	7,240	11,160	0.13
HMX7G	.4375	.4375	.4370	1.1250	2.1250	1.3750	.5000-20	0.8120	.5860	7,620	13,660	0.18
HMX8G	.5000	.5000	.5000	1.3120	2.4380	1.5000	.6250-18	0.9370	.6980	11,920	19,340	0.30
HMX10G	.6250	.6250	.5620	1.5000	2.6250	1.6250	.7500-16	1.1250	.8390	13,940	21,080	0.46
HMX12G	.7500	.7500	.6870	1.7500	2.8750	1.7500	.8750-14	1.3120	.9780	21,570	29,800	0.72